

# ISLAND BAR / PT (Side)

## GLASSWASHER / PT STATION at SIDE

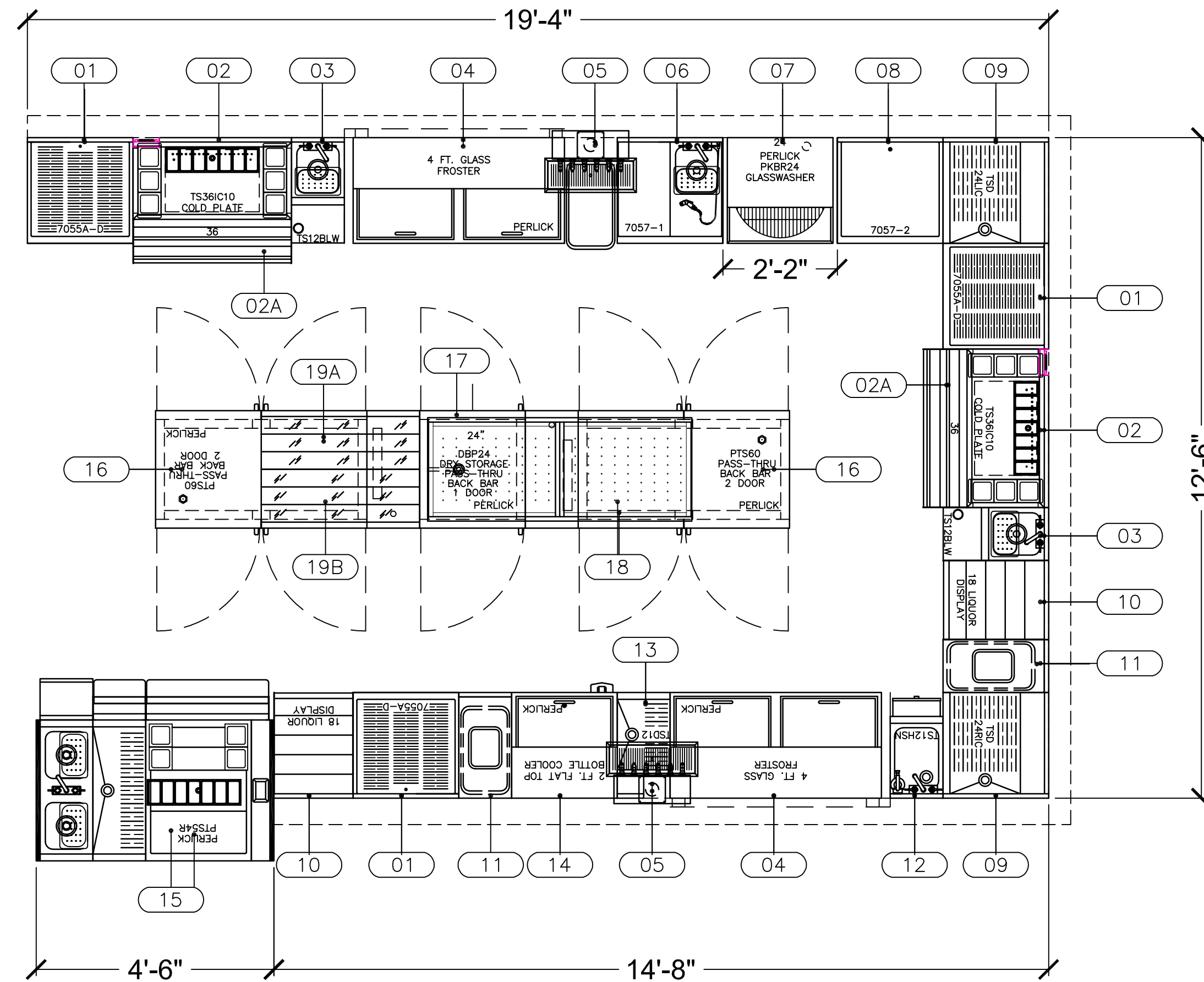

PERLICK EQUIPMENT SCHEDULE

Item No	Qty	Model Number	Manufacturer	Equipment Category	Equipment Remarks	Volts	Cycle	Phase	Amps	HP	Plug	Electrical AFF (in)	Cold Water Size (in)	Hot Water Size (in)	Drain Size (in)
01	3	7055A-D	Perlick	Underbar Dry Storage											1
02	2	TS36C10	Perlick	Underbar Ice Chest	7055-265A Chase, BW6-36 Wells, CC7 Tray										0.5
02A	2	SR-D36	Perlick	Underbar Speed Rail											
03	2	TS12BLW	Perlick	Underbar Blender Station	End Splash (L), 7055-52 Dump Box							18	0.375	0.375	1.5
04	2	FR48	Perlick	Froster/Chiller, Glass/Mug/Plate		115	60	1	6.2	0.33	X				
05	2	4006-6B	Perlick	Dispensing Head, Draft Beer, Tee Tower	C18640A Drain Pan								0.375	0.375	1.5
06	1	7057-1	Perlick	Glasswasher Accessory											1.5
07	1	PKBR24	Perlick	Glasswasher		120	60	1	5.4		X			0.5	1.25
08	1	7057-2	Perlick	Glasswasher Accessory											0.5
09	1	TSD24RC	Perlick	Underbar Fillers & Drainboards											1.5
09	1	TSD24LC	Perlick	Underbar Fillers & Drainboards											1.5
10	2	TS18LS	Perlick	Underbar Liquor Display	BC18 Guardrails										
11	1	TSF128TB	Perlick	Bridge Trash											
11	1	TSF128TB	Perlick	Bridge Trash	Leg Panel (L)										
12	1	TS12HSN	Perlick	Underbar Handsink									0.375	375	1.5
13	1	TSD12	Perlick	Underbar Fillers & Drainboards	7055-67A Bev.Chase (L)										1.5
14	1	BC24	Perlick	Cooler, Bottle Opener / Receiver		115	60	1	3.2	0.2	X				1.5
15	1	PTS54R	Perlick	Underbar Pass-Thru Service Station	CC7 Cond. Tray								0.5	0.5	0.5
															1.5
															1.5
16	2	PTS60	Perlick	Back Bar Equipment	Adj. Legs 6-7.25"	120	60	1	5.5	0.25	X				
17	1	DBP24	Perlick	Back Bar Equipment	Adj. Legs 6-7.25"										
18	1	GMS24X60	Perlick	Display, Iced	(15') 1390D										0.5
19A	1	LMD3-36R	Perlick	Lighted Merchandise Display		100-240			1.2		X				
19B	1	LMD3-36L	Perlick	Lighted Merchandise Display		100-240			1.2		X				
									1.5		X				

- SYMBOLS**
- ⊕ H HOT WATER CONNECTION
  - ⊖ C COLD WATER CONNECTION
  - ⊕ D DRAIN (ICE CHESTS)- 1/2" MALE NPS
  - ⊖ D DRAIN - 1-1/2" MALE NPS
  - ⊕ ELECTRICAL CONNECTION
  - ⊕ DUPLEX OUTLET

I HAVE CHECKED ALL DIMENSIONS AND EQUIPMENT LOCATIONS ON THIS DRAWING FOR ACCURACY:

- Approved for fabrication as shown.
- Approved for fabrication with changes as noted.
- Drawing requires changes as noted; submit revised drawing for my approval.

PLEASE TYPE OR PRINT:

NAME \_\_\_\_\_ DATE \_\_\_\_\_  
 TITLE \_\_\_\_\_ DATE \_\_\_\_\_  
 COMPANY \_\_\_\_\_



\*\* DO NOT USE THIS DRAWING FOR CONSTRUCTION SPECIFICATIONS \*\*  
 This drawing is provided solely to illustrate the positioning of Perlick Equipment.  
 Non-Perlick Equipment or Features which have been copied or derived from other sources are shown on this drawing for reference only.

SCALE: 1/2" = 1'-0"	PROJECT: BAR 12	PROJECT NO: 1002109	EXHIBIT NO: A
REV. DATE:	DRAWN BY: jab	DRAWING NO:	
DESIGN DATE: 05/10/2016			
DATE PLOTTED: D	SHEET: 1 of 1	PROPERTY OF THE PERLICK CORP. NOT TO BE COPIED OR USED DETRIMENTAL TO OUR INTERESTS.	